



**Martha Vidya Prasarak Samaj's
KARAMVEER SHANTARAMBAPU
KONDAJI WAVARE ARTS, SCIENCE
and COMMERCE COLLEGE, CIDCO,
NASHIK**

2023 - 24 KI: 4.1 Physical Facilities



Assessment and Accreditation
Criterion- IV Infrastructure and Learning Resources

QIM 4.1.1. The Institution has adequate infrastructure and physical facilities for teaching- learning. viz., classrooms, laboratories, computing equipment etc.



Maratha Vidya Prasarak Samaj's
KARMAVEER SHANTARAMBAPU KONDAJI WAVARE
ARTS, SCIENCE AND COMMERCE COLLEGE, CIDCO
Uttamnagar, Nashik- 422 008 (Maharashtra)

Principal

Affiliated to Savitribai Phule Pune University

Id. No. PU/NS/ASC/047/1993

Prof. (Dr) S. K. Kushare
M.Sc., Ph. D.

AISHE C-42086NAAC Re-accredited 'B+' Grade (IV Cycle 2023-28, CGPA 2.66)

Best College Award of Savitribai Phule Pune University Pune in 2009-10 and 2021-22

Internal Quality Assurance Cell

Criterion IV: Infrastructure and Learning Resources

Year 2023-2024

4.1 Physical Facilities

4.1.1. *The Institution has adequate infrastructure and physical facilities for teaching- learning. viz., classrooms, laboratories, computing equipment etc.*

Basic infrastructure facilities

Table of Contents

4.1.1.1 Campus and built-up area measurements.....	3
4.1.1.2 Building and Campus View.....	4
4.1.1.3 Blueprint of Institute Buildings	6
4.1.1.4 Registration letter of Institute Land.....	7
4.1.1.5 Possession Letter of Land from C.I.D.C.	10
4.1.1.6 Campus Information.....	11

Infrastructural facilities Building and Campus

4.1.1.1 Campus and built-up area measurements

Facilities	Area in Sq. ft.
Campus area	3.5 Acers
Build up Area	67376.09 sq. ft
Laboratories (13)	900 Sq. ft. each
I.T. Lab.	1025 Sq. ft
Seminar Halls	3160 Sq. ft
IQAC Office	550 Sq. ft
Classrooms (31)	900 Sq. ft. each +567 Sq. ft.
Video/LMS Centre	185 Sq. ft.
Principal Cabin	525 Sq. ft
Common Staff Room	640 Sq. ft
Administrative Office	902 Sq. ft
Record Room (Administrative Record)	256 Sq. ft
Department's cabins/ Rooms (17)	180 Sq. ft
Library	1510 Sq. ft
Reading Rooms	Boys Room: 958 Sq. ft. Girls Room: 758.Sq. ft. Staff Room: 180 Sq. ft.
Network Resource Centre	93.75 Sq. ft.
Examination Dept.	1071 Sq. ft
Sports and Gymnasium	840 Sq. ft.
N.S.S.	300 Sq. ft
N.C.C.	420 Sq. ft.
Storeroom	108 Sq. ft.
Yoga Centre	3160 Sq. ft
Porch Area	10,754 Sq. ft.
Four-wheeler Parking sheds	986 Sq. ft
Two – wheeler Parking sheds	744 Sq. ft.
Toilet Units (8 Blocks)	1440 Sq. ft.
Y.C.M.O.U. learning Centre	248 Sq. ft.
Bicycle Parking Stands	17 Stands
RO Plant (1)	82.5 sq. ft.
Water Purifier (2 each)	9 Sq. ft.
Vermi Compost Unit	35 Sq. ft.
Turbo Generator	96 Sq. ft.
Solar System (48 panels & 15.3 KW)	1530 Sq. ft.
CCTV Cameras	74 No.
Botanical garden	1519 Sq. ft.

Table Description: Table showing measurement areas in different units of various facilities.

4.1.1.2 Building and Campus View



Building View 1



Campus View 2



Old Building 3

New Building 4



4.1.1.3 Blueprint of Institute Buildings

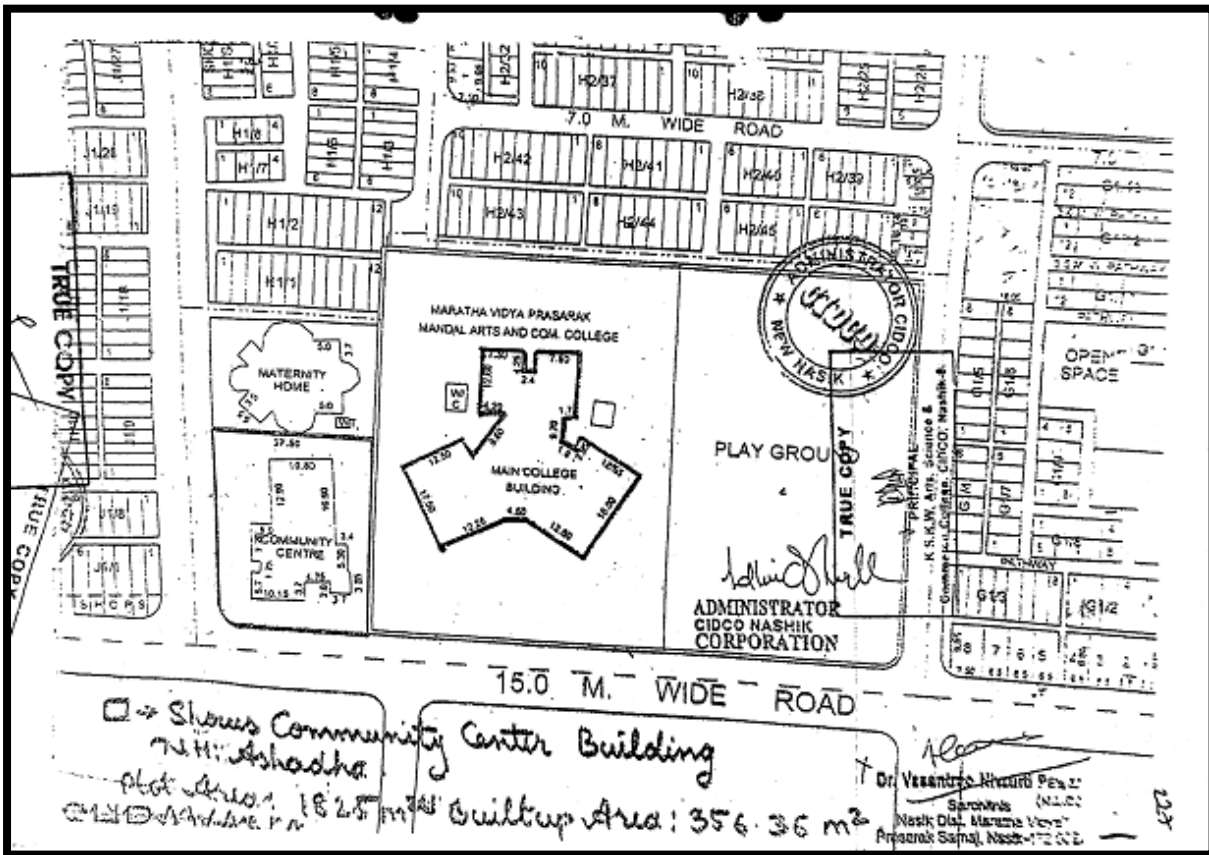

4.1.1.4 Registration letter of Institute Land

Certificate of Registration
No. 34912.

It is hereby certified that the Public Trust described below has this day been duly registered under the Bombay Public Trusts Act, 1950 (Bom. XXIX of 1950), at the Public Trusts Registration office, Poona Region, Poona.

Name of Public Trust : Maratha Vidya Prasarak Samaj, Nasik.

Number in the Register of Public Trust : A 436

Certificate issued to Shri. B. S. Hiray,

Given under my hand, this 12th day of November 1954

Signature : Sd/- XXX
Designation :
Assistant Charity Commissioner,
Poona Region, Poona

(SEAL)
(ASST. CHARITY COMMISSIONER
POONA REGION)

Registration Letter 6

[विशेष-ध. आ. (मुं. शा. वि.) ५०-य.]

No. ०७३३१२



नोंदणी प्रमाणपत्र

संस्था नोंदणी अधिनियम, १८६०

(१८६० चा अधिनियम २१)

मध्यगार / १८३ / २०११ / नाशिक नोंदणी क्रमांक :

याद्वारे असे प्रमाणित करण्यात येते की, कृषिवीर शांताशम वापू यांचे कला विज्ञान

या चाणिऊय मध्यविद्यालय (मजी) विद्यार्थी संस्था सिडको ता. जि. नाशिक

खालील तारखेस संस्था नोंदणी अधिनियम, १८६० (सन १८६० चा अधिनियम २१) अन्वये योग्यरित्या नोंदणी करण्यात आली.

तारीख : ४/३/२०११ रोजी माझ्या सहीनिशी दिले.



संस्थांचे सहायक निबंधक,

..... महसुदयक संस्था निबंधक विभाग,
नाशिक प्रदेश, नाशिक

शुद्ध

शहर व औद्योगिक विकास महामंडळ (महाराष्ट्र) मर्यादित

नोंदणीकृत कार्यालय :

'निर्मल', दुसरा मजला, नरिमन पॉईंट,

मुंबई - 400 021.

दूरध्वनी : 202 24 81 / 202 24 20 / 202 25 79

फॅक्स : 202 25 09 ग्राम : सिआयटीडब्लूआयएन.

प्रशासकीय कार्यालय :

मुंबई अण्णा रोड,

नविन नाशिक - 422 009.

दूरध्वनी : 2392679, 2392268

फॅक्स : (0253) 2392801.

संदर्भ क्र. : CIDCO / ADMN / NSK / NO. : 748

दिनांक : 23/11/09

CERTIFICATE

This is to certify that the ^{Survey} Plot No. 915 & 940 Sector —
NH. Ashadha has been legally transferred in the name of
S/tn. / S/tn. Nashik District Maratha Vidya Prasarak Sam
of Nashik. The plot is on outright purchase Basis on lease hold right of Sixty
years and CIDCO has No objection to mortgage the lease hold rights title and
interest of non-transferable lease for sixty years in the said Plot to the
'Kalpappa Aawade Ichalkaraji Janata Sahakari
Bank Ltd. Ichalkaraji, Sharan
Road, branch.
for the purpose of raising loan.



[Signature]
Administrator,
CIDCO, New Nashik.

To,
S/tn. / S/tn. Nashik District Maratha V. P. Samaj

Survey NO. 915 & 940

Composit School building
CIDCO Nashik

4.1.1.5 Possession Letter of Land from C.I.D.C.

Possession Letter of Land from C.I.D.C. 9

Sr. No. ०००६१०

City & Industrial Development Corporation of Maharashtra Nashik

POSSESSION RECEIPT

I, Shri. Nashik District Maratha Samaj, Nashik. ^{PE} vidya Prasarak ^{PE}
 have this day of 3rd Sept. 2004 199 received possession at the
 Type of House No. / Shop No. of Building No. Community Centre
 in Sector Near Uttamngar in Neighbourhood Ashadha at New
 Nashik Before taking over possession, I have verified the fitting, fixtures and amenities
 in the above, house/shop and they are according to the plans & specifications enclosed
 with the agreement I have inspected the house/shop and satisfied myself, I accept the
 above said house/shop Type of House/shop No. of
 Building No. Community Centre in Sector Near Uttamngar in Neighbourhood
Ashadha after carrying out the rectification to my satisfaction.
 Plot Area - 1825.00 sq. mt.
 Built up Area - 356.36 sq. mt.

Date 3/09/2004 PK
(Signature of Allottee)

Possession given by B. S. PATIL
 Asstt. Engr. (MKT.)
 CIDCO, New, Nashik
 (Sub Engr. / A. E. & T. A.)
 CIDCO, New Nashik.

Name P. K. Thombare
 Estate Manager
 Maratha Vidya Prasarak Samaj, Nashik.

4.1.1.6 Campus Information

Facilities	Existing	Newly added
Campus area	3.5 Acers	--
Build up Area	67376.09 sq. ft	--
Class rooms	44	--
Laboratories	13	1
I T Lab	01	
Seminar Halls	01	--
IQAC Office	01	
Classrooms with LCD facilities	13	
Classrooms with Wi-Fi/ LAN	44	--
Seminar halls with ICT facilities	01	--
LMS Room	01	
Principal Cabin	01	
Common Staff Room	01	
Administrative Office	01	
Department's cabins/ Rooms	18	
Library	01	
Reading Rooms	03	
Examination Dept.	01	
N.S.S.	01	
Physical Education Department	01	
Store Room	01	
Porch	07	
Parking sheds	01	--
Four-wheeler Parking	01	
Two – wheeler Parking	01	
Bicycle Parking	01	
Toilet Blocks	09	
Y.C.M.O.U. learning Centre	01	



Principal
 Maratha Vidya Prasarak Samaj's
 Karmaveer Shantarambapu Kondaji Wavare
 Arts science and Commerce College
 Uttamnagar, CIDCO Nashik-422008